



melvyn
Danes
ESTATE AGENTS



Sheldonfield Road
Sheldon
£285,000

Description

A largely extended detached house on one of the most desirable roads in Sheldon offering no onward chain. The property is a blank canvas and ready for the new owners to put their own stamp on it, within walking distance to a wide variety of local amenities and overlooks Sheldon Country park. Briefly comprising; entrance hall, lounge, extended rear reception room and extended kitchen to the ground floor. On the first floor you will find three good size bedrooms, shower room and a separate W.C. Benefitting from central heating, double glazing, front and rear gardens and off road parking.



Accommodation

Front Driveway

Enclosed Porch

Entrance Hall

Front Reception

11'9 x 16' into bay (3.58m x 4.88m into bay)

Rear Reception

9'7 x 22'10 (2.92m x 6.96m)

Extended Kitchen

7'10 x 22'10 (2.39m x 6.96m)

Landing

Bedroom One

10'6 x 14'1 into bay (3.20m x 4.29m into bay)

Bedroom Two

11' x 11'3 (3.35m x 3.43m)

Bedroom Three

7'7 x 7'5 (2.31m x 2.26m)

Shower Room

7'7 x 5'6 (2.31m x 1.68m)

Seperate W.C

4'2 x 2'5 (1.27m x 0.74m)

Rear Garden



TENURE: We are advised that the property is Freehold

BROADBAND: We understand that the standard broadband download speed at the property is around 15 Mbps, however please note that results will vary depending on the time a speed test is carried out. The estimated fastest download speed currently achievable for the property post code area is around 1800 Mbps. Data taken from checker.ofcom.org.uk on 26/02/2025. Actual service availability at the property or speeds received may be different.

MOBILE: We understand that the property is likely to have current mobile coverage (data taken from checker.ofcom.org.uk on 26/02/2025). Please note that actual services available may be different depending on the particular circumstances, precise location and network outages.

VIEWING: By appointment only with the office on the number below.

CONSUMER PROTECTION FROM UNFAIR TRADING REGULATIONS 2008: These particulars are for general guidance only and are based on information supplied and approved by the seller. Complete accuracy cannot be guaranteed and may be subject to errors and/or omissions. They do not constitute representations of fact or form part of any offer or contract. Any Prospective Purchaser should obtain verification of all legal and factual matters and information from their Solicitor. Licensed Conveyancer or Surveyors as appropriate. The agent has not sought to verify the legal title of the property and the buyers must obtain verification from their solicitor. Photographs are provided for illustrative purposes only and the items shown in these are not necessarily included in the sale, unless specifically stated. The agent has not tested any apparatus, equipment, fixtures, fittings or services mentioned and do not by these Particulars or otherwise verify or warrant that they are in working order.

MONEY LAUNDERING REGULATIONS: Under anti-money laundering legislation, we are obliged to confirm the identity of individuals and companies and the beneficial owners of organisations and trusts before accepting new instructions, and to review this from time to time. To avoid the need to request detailed identity information from intending purchasers, we may use approved external services which review publicly available information on companies and individuals. However, should those checks, for any reason, fail adequately to confirm identity, we may write to you to ask for identification evidence. If you do not provide satisfactory evidence or information within a reasonable time, we may have to stop acting for you and we would ask for your co-operation in order that there will be no delay in agreeing the sale.

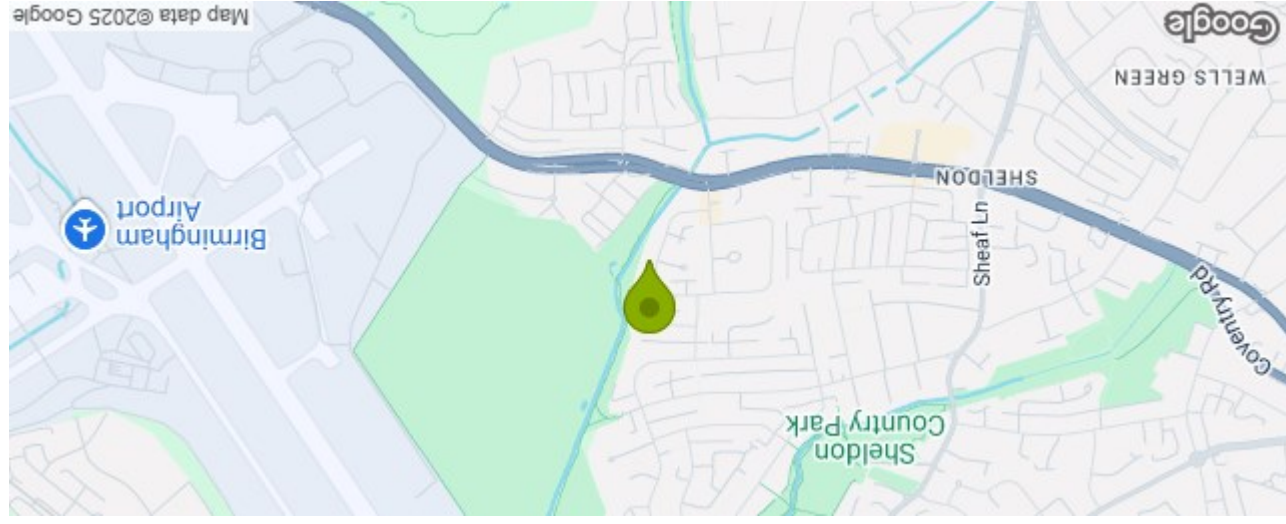

73 Sheldonfield Road Sheldon Birmingham B26 3RR Council Tax Band: D

Energy Efficiency Rating	
Potential	83
Current	60

England & Wales	
Very energy efficient - lower running costs	(92 plus) A
(81-91) B	
(69-80) C	
(55-68) D	
(39-54) E	
(21-38) F	
(1-20) G	
Not energy efficient - higher running costs	

EU Directive 2002/91/EC

Total area: approx. 109.9 sq. metres (1183.0 sq. feet)

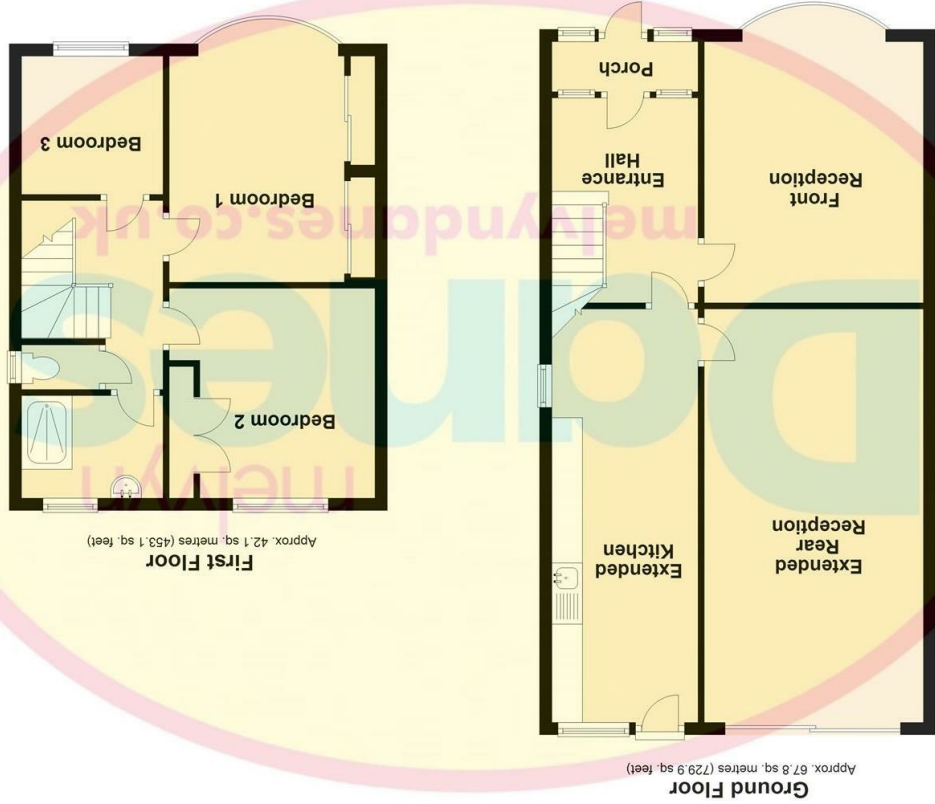

Please note that all measurements and floor plans are approximate and quoted for general guidance only and whilst every attempt has been made to ensure accuracy, they must not be relied on and do not form part of any contract.